

PORC

887-01-1995

Barb Dean
321 E. Meyer Ave.
New Castle, PA 16105

Feb. 12, 1996

P.O.R.C.

HOARY REDPOLI (Carduelis hornemanni) DECEMBER 27, 1995

Observer Barb Dean
Location 321 E. Meyer Ave. New Castle, PA 16105

Habitat My small city backyard which measures approx. 50'x50'. The East side of the yard is lined with 6 birch trees, dogwood and hemlocks. The North side of the yard is lined with 4 pine trees, dogwood and birch. There are 2 small ponds that were covered with 2' of snow.

Time 2:30 PM

Length of observation was no more than 5 minutes.

Weather Yard was covered with from one to at least two feet of snow from drifting. Bitterly cold and below freezing and sky overcast but bright lighting.

Equipment used was 10x Zeiss binoculars

Food Big feeder out back had thistle but almost empty and the sunflower seeds were also almost gone.

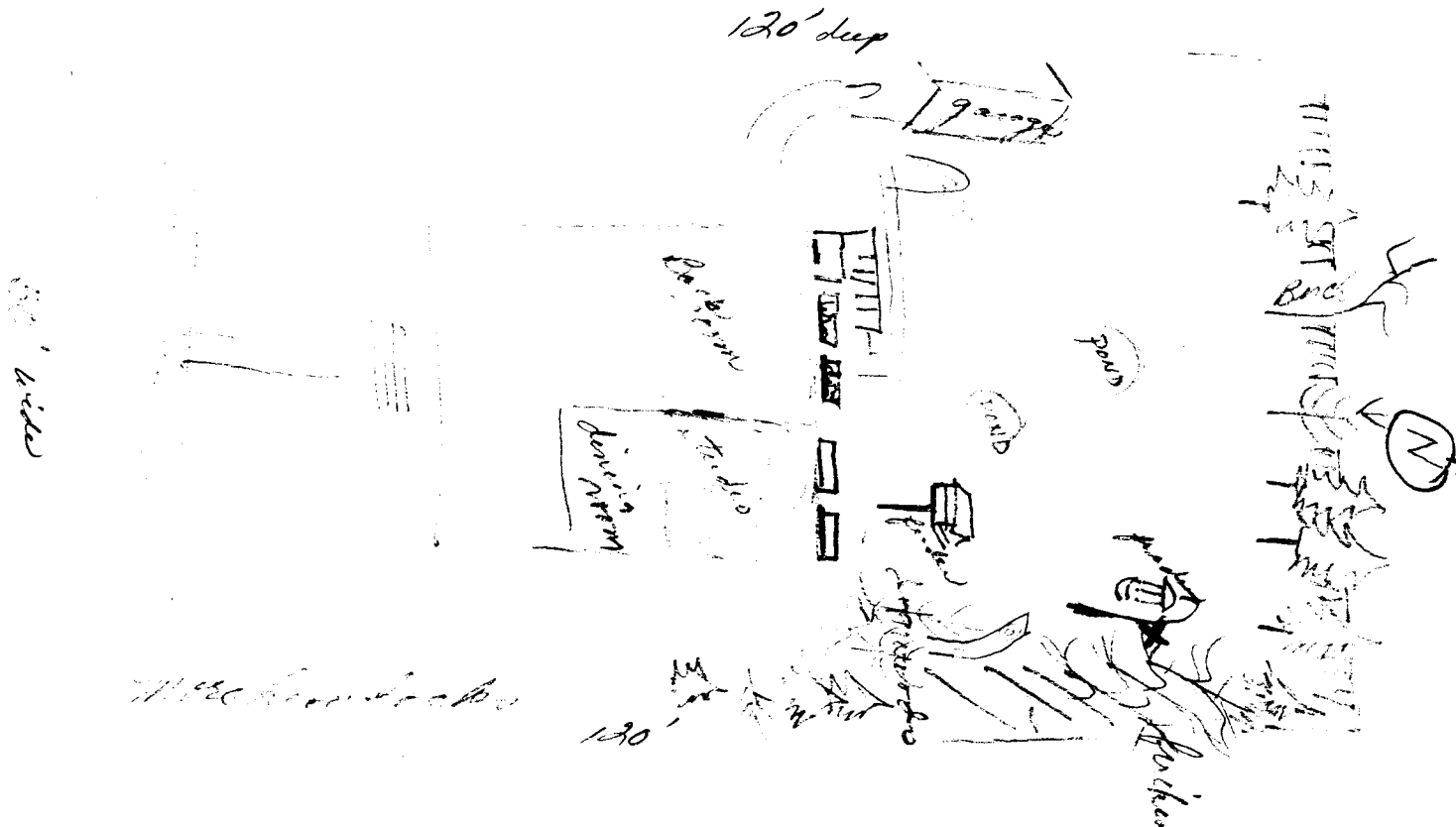

887-01-1995

Rarb Dean

HOARY REDPOLL 12/27/95

I returned from my parents home around 1:30 PM and did not notice any birds in the backyard as I walked into my house. I began to do some work in the back room. I sat down on the couch and glanced up through the window. It was 2:30 PM. I saw the silhouettes of some small birds at the catkins of the birch trees. My first thought was that Siskins had come in because they always go to the catkins. I got up and went to the window. I was about 20' away from the 7 birds. My eyes immediately were drawn to the very white bird that was facing West as it perched on the branch of the birch tree. I knew it was Redpoll and I was alert to the fact that it could be Hoary. I quickly glanced at the other 6 birds. Three were at the catkins and the other three were on some branches about 3' above the whiter Redpoll. The three on the catkins were 3 to 4' above and away from the three Common Redpoll and these 6 Common Redpoll were much darker and browner and more streaked than the whiter bird. The whiter bird looked more grey than brown and without binoculars I didn't see any streaking on the undersides of this whiter bird. I wanted my binoculars bad. The trouble was that the three C. Redpoll on the branches were also facing West and they too were looking very alert and also looking side to side as though they were going to take off any minute. Without binoculars, the whiter bird was about eye level and I could see the whole left side of the bird and sometimes a little bit of the right side of its head. The other things I could see without binoculars was that the possible Hoary had a conspicuous white eyebrow. It was much whiter than the C. Redpolls. Also the color on the breast of the C. Redpolls was a deep pink to light red and the color on the breast of the whiter bird was a pale pink blush and not so extensive. As the whiter bird moved slightly, you could say I had a 3/4 view at times and a pretty good view of the left side of the bird at other times. The black chin really stood out more than it did on the Common Redpolls because it was so much lighter around that area than it was on the Commons. The same held true for the cap. The red on the cap seemed neater and brighter than it showed on the C. Redpolls because on the whiter bird it was much lighter around the cap. The cap was not orange-red as in some descriptions, it was a deep bright blood red. Without binoculars, the flank & undertail covert and belly were white. Legs, eyes, forked tails and wing feathers closest to the rump looked black. Those wing feathers lined with white.

Since the birds did not leave after two minutes or less, I decided to go into the studio for my binoculars. The studio and back room of the house are side by side and both have windows facing North but the studio windows are almost floor to ceiling. I can't move much out there because I am always afraid the birds will see me. I got the binoculars and crept up to the window.

I scanned the whiter bird again. I could see the smaller yellow bill and the black tip. The undersides of the bird were white and clean. The left side of the bird had six or seven dashes of darker color running in a ragged line from a little above the top white wing bar to a little below the bottom wing bar. The grey dashes had white all around them because they were just a little away from the wing edge. The breast had a pale pink blush that did not extend up to the face. In other words the color stayed just on the breast.

It may be important to say that my house is about 4 to 5 feet off the ground before the floor level starts, so I'm up off the ground when viewing the bird. I'm also 11' more to the East when I view birds from the studio. I was also able to see the left side of the rump of this bird and it was white.

887-01-1995

Barb Dean

Hoary Redpoll 12/27/95

I decided to go to the dining room to get my camera. I viewed the bird a minute or so with binoculars.

It only took seconds to get the camera but when I hit the studio I couldn't see the bird but went to the window anyway. I checked through the viewfinder of the camera then put it down on the stool by the easel and picked up my binoculars. That's when I realized the whiter bird was perhaps 6 feet below and perhaps 6' to the right of me and it didn't do me any good at all. All I could see was a tiny bit of white here or there among the dogwood and hemlock branches and I was blocked in by furniture. Almost at the same time I began to look out at the other 6 redpolls and caught all 7 birds flying in a NW direction out of the yard. The Hoary was at the rear and I got perhaps a 3 second look. I got them in my eyesight when they were about 15' away from my back fence and they flew out between the birch and pine trees. All I remember was that the rump on the Hoary was white and several of the C. Redpoll at the front of the group dipped before going over the fence but the Hoary did not. When they flew out of the yard, I was not using binoculars.

My only experience with Redpolls is from the yard. I have never seen a Hoary. Several years ago, I used to get a very tame C. Redpoll who would stay for a week or so at my feeders. I used to sit in the back yard and go over it pretty good with my binoculars. That bird returned several years in a row. There was a striking difference between any C. Redpoll I've ever seen and what I believe was this Hoary.

About an hour later 3 C. Redpoll appeared on the birches and only stayed a few minutes.

The next day, 12/28/95, I had 8 C. Redpoll here on birches at 11:30 AM.

On 1/7/96 Lawrence Co. had 1 C. Redpoll just N. of me .

Barb Dean

Pennsylvania Ornithological Records Committee

Voting Tabulation - Round # 1 of

Species: **Hoary Redpoll** (*Carduelis hornemanni*)

Date of Sighting: **27 December 1995 to 27 December 1995**

Location: **NEW CASTLE**

County: **LAWRENCE**

Observer(s): **Barb Dean**

Date of Submission: **1996**

Submitted by: **Barb Dean**

Written Description: **YES** Photo: **NO** Specimen: **NO**

Recording: **NONE**

| Member | Class I | Class II | Class III | Class IV | Class V | | | Abstain |
|-----------------|---------|----------|-----------|----------|---------|---|---|---------|
| | | | | | A | B | C | |
| F. Haas | | | | X | | | | |
| N. Pulcinella | | | X | | | | | |
| E. Kwater | | | X | | | | | |
| R. Ickes | | | X | | | | | |
| G. McWilliams | | | | X | | | | |
| P. Schwalbe | | | | | | X | | |
| S. Feldstein | | | | X | | | | |
| TOTALS | | | 3 | 3 | | 1 | | |
| DECISION | | | | X | | | | |

Comments:

Signature (Secretary):

L C Haas

Date:

2-22-97